

The Plans for the Tram Route and Depot

Map 14

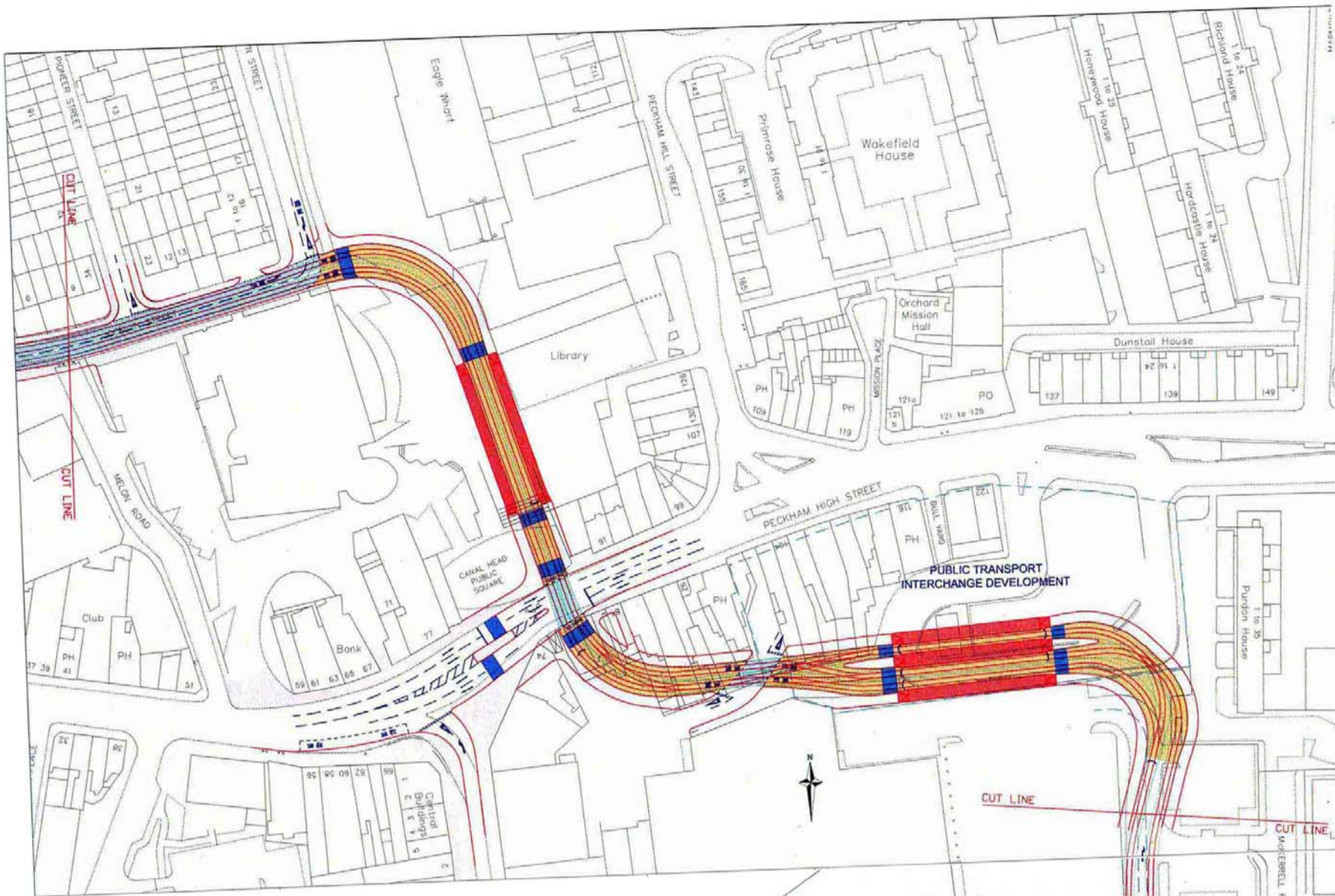

Map 15

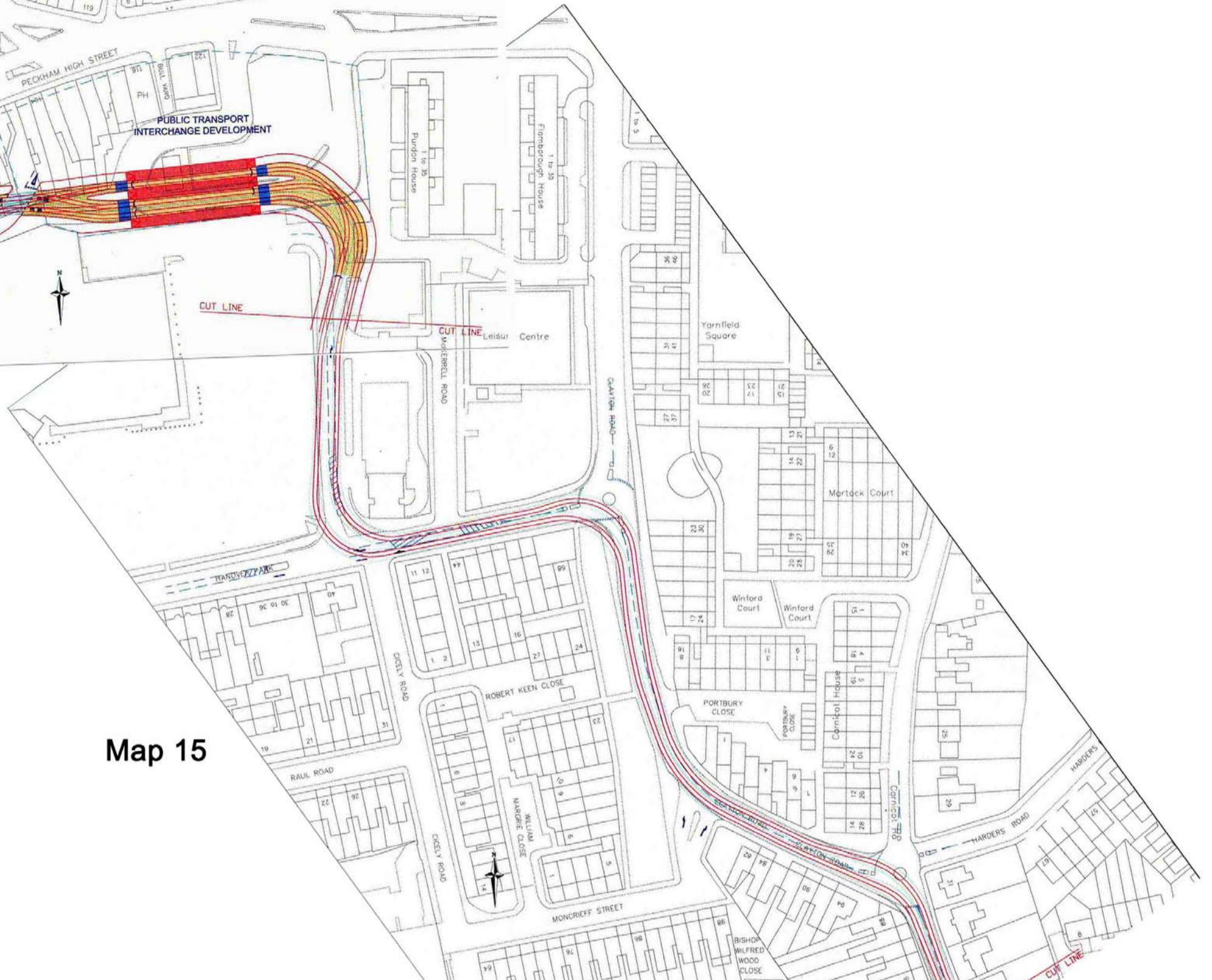

Map 16

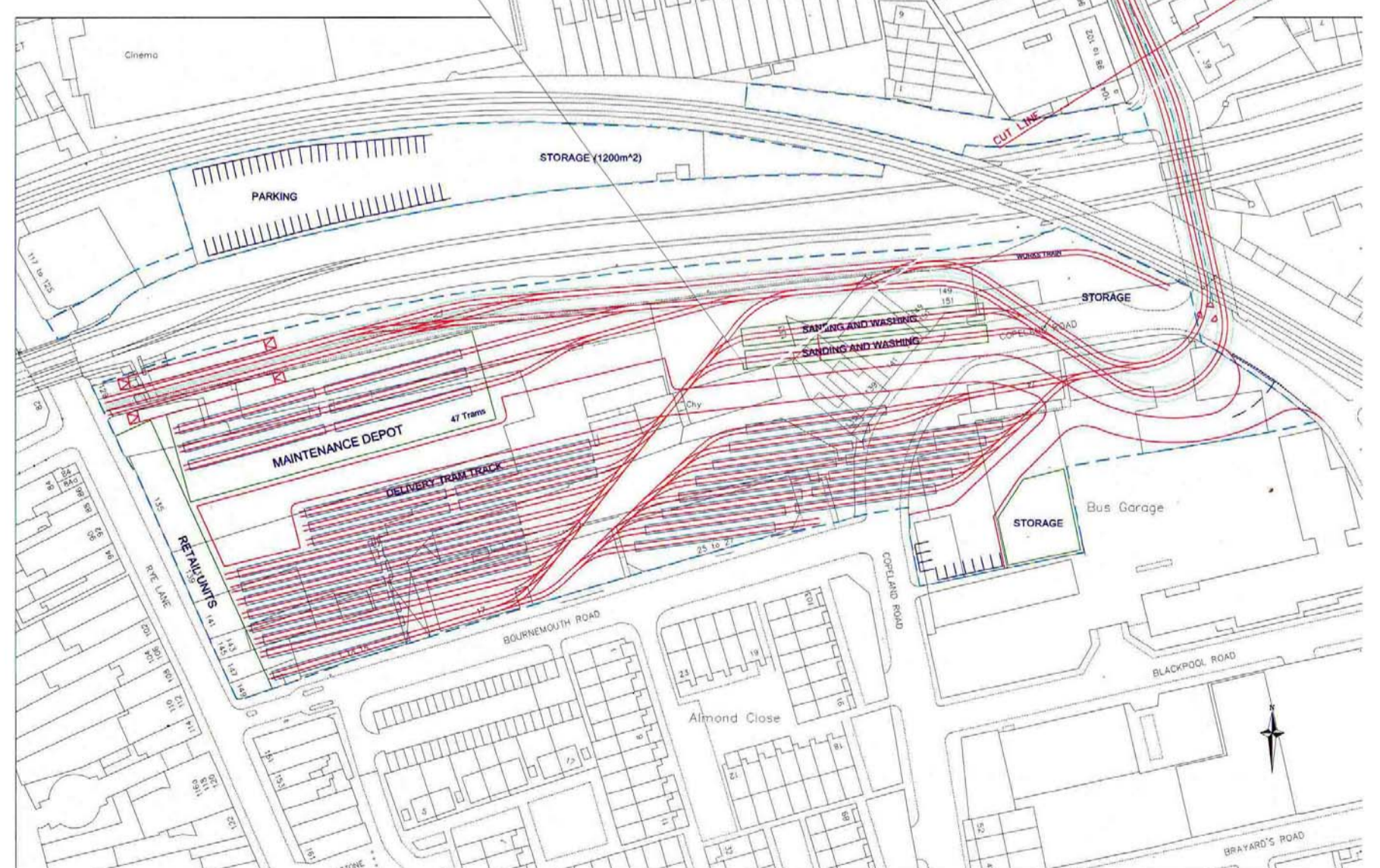

Key to Map 14

	Key Segregated Tram Lane Tram DKL within shared traffic lane Bus & Tram Lane Tram Stop Bus Lane Controlled Pedestrian Crossing	Pedestrian & other non-vehicular areas Dedicated Cycle Facility Soft Landscaping Areas Proposed Cartageway Markings Proposed kerb alignment Proposed Tram Tracks Kings Cross Proposed Development	Railway Systems Consultants Ltd Tel: +44 (0) 1753 813 280 Fax: +44 (0) 1753 817 132 Email: rsc@rsc.co.uk Web: www.rsc.co.uk	Scale 1:1000 @ A3 Cross River Tram - Route Proposals Dwg No - RSC082/T035/P14 Print Date - 19/11/2004	PECKHAM BRANCH TRACK ALIGNMENT (Sheet 14 of 16)

Key to Map 15

	Key Segregated Tram Lane Tram DKL within shared traffic lane Bus & Tram Lane Tram Stop Bus Lane Controlled Pedestrian Crossing	Pedestrian & other non-vehicular areas Dedicated Cycle Facility Soft Landscaping Areas Proposed Cartageway Markings Proposed kerb alignment Proposed Tram Tracks Kings Cross Proposed Development	Railway Systems Consultants Ltd Tel: +44 (0) 1753 813 280 Fax: +44 (0) 1753 817 132 Email: rsc@rsc.co.uk Web: www.rsc.co.uk	Scale 1:1000 @ A3 Cross River Tram - Route Proposals Dwg No - RSC082/T035/P15 Print Date - 19/11/2004	PECKHAM BRANCH TRACK ALIGNMENT (Sheet 15 of 16)

Key to Map 16

	Key Segregated Tram Lane Tram DKL within shared traffic lane Bus & Tram Lane Tram Stop Bus Lane Controlled Pedestrian Crossing	Pedestrian & other non-vehicular areas Dedicated Cycle Facility Soft Landscaping Areas Proposed Cartageway Markings Proposed kerb alignment Proposed Tram Tracks Kings Cross Proposed Development	Railway Systems Consultants Ltd Tel: +44 (0) 1753 813 280 Fax: +44 (0) 1753 817 132 Email: rsc@rsc.co.uk Web: www.rsc.co.uk	Scale 1:1000 @ A3 Cross River Tram - Route Proposals Dwg No - RSC082/T035/P16 Print Date - 19/11/2004	PECKHAM BRANCH TRACK ALIGNMENT (Sheet 16 of 16)

This diagram shows the proposed route of the Cross River Tram as it comes into the Peckham area. It was created from three separate plans drawn by the Railway Systems Consultants, Transport for London and the Cross River Partnership. The Keys for the plans from which this diagram was created can be seen to the left.